



REPLACEMENT SALT CHLORINATION CELL
For Nature2 Fusion Soft Systems



INSTALLATION AND OPERATION MANUAL
READ AND FOLLOW ALL INSTRUCTIONS SAVE THESE
INSTRUCTIONS

Thank you for your purchase of a CaliMar® salt cell. Our cells are designed to meet or exceed original specifications, for optimal performance and reliability. The CMARCFS12-1Y and CMARCFS40-1Y are direct replacement cells for Zodiac® Nature2® Fusion Soft chlorination systems.

CaliMar® Cell Part Numbers	Volume in Gallons	Warranty	Compatible with Zodiac® Cell Part Numbers	Compatible with Nature2® Fusion Soft Systems
CMARCFS12-1Y	12,000	1-Year*	R0502800	FSOFT700
CMARCFS40-1Y	40,000	1-Year*	R0503000	FSOFT1400

*See warranty documentation for details.

NOTE: CaliMar® CMARCFS salt cells are not produced, manufactured, or sold by Zodiac® Pool Products. Neither CaliMar® nor its CMARCFS salt cells are affiliated with Fluidra® USA. The use of such trademarks herein is for informational purposes only. Model and system compatibility designations are included for informational purposes only.

Contents

- Important Safety Instructions 4
- Installation 4
- Operation 5
- Maintenance 5
- Limited Warranty 6

Important Safety Instructions

The CMARCF512-1Y AND CMARCF540-1Y cells can be used in Nature2® Fusion Soft systems. No system configuration is necessary.

Installation

IMPORTANT: Always make sure the input power is completely disconnected and all pool equipment is shut off before attempting any service procedures. All servicing should be performed by a qualified professional.

1. Turn the power to both the filter pump and the cell's power center off and close off any valves.
2. Unplug the yellow DC cable connector from the cell.
3. Unscrew the cell's large collar and remove the old salt cell from the plumbing.
4. Inspect the O-ring on the unions connecting the cell to the plumbing to see if it needs replacement. If so, replace it before installing the new cell.
5. Place the replacement salt cell in line and secure the cell collar by hand. Do not overtighten with the use of tools.
6. Plug the DC cable connector back onto the cell and turn the filter pump and cell power center both back on.
7. Refer to the owner's manual of your salt system for regular operation instructions.

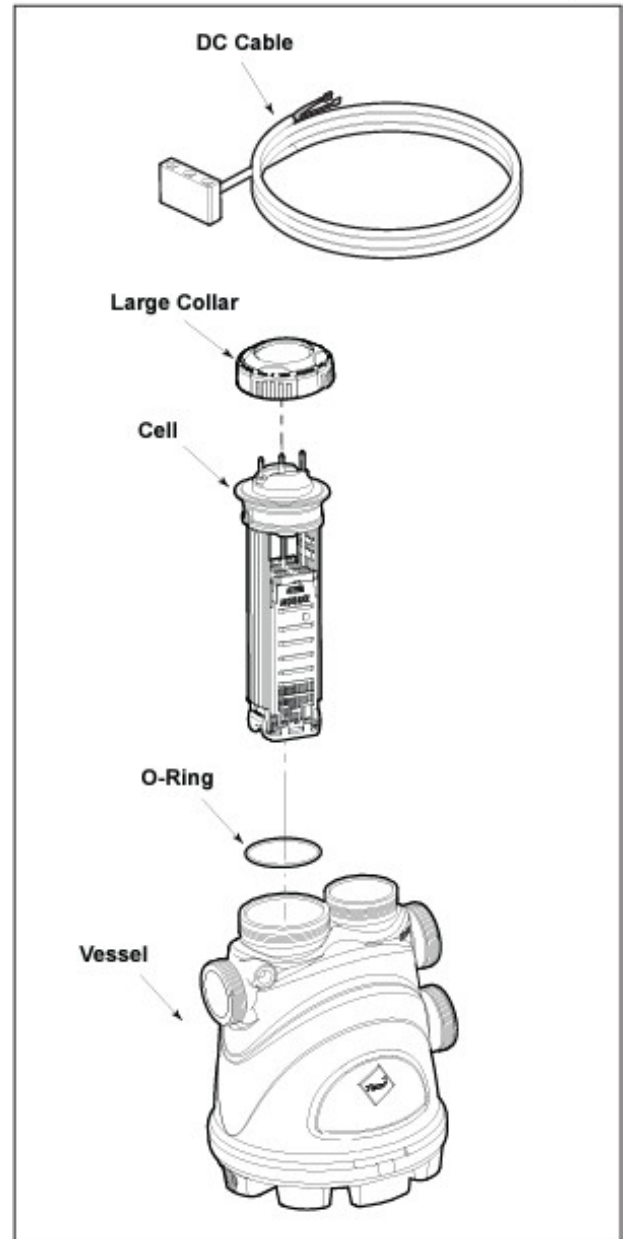

Operation

NOTE: The total working hours for the cell replacements should be less than 8 hours total per day. If you are using a variable speed pump for 24 hours a day, be sure to adjust the chlorine output to 25-30%. If the pump is only running 10 hours per day adjust the chlorine output between 60-80%.

You can use this calculation to determine the appropriate chlorine output for your pool at the suggested 6 hours per day.

- Pump running 24 hours a day x 25% chlorine output = 6-hour cell run time per day at 25%
- Pump running 20 hours a day x 30% chlorine output = 6-hour cell run time per day at 30%
- Pump running 15 hours a day x 40% chlorine output = 6-hour cell run time per day at 40%
- Pump running 12 hours a day x 50% chlorine output = 6-hour cell run time per day at 50%
- Pump running 8 hours a day x 75% chlorine output = 6-hour cell run time per day at 75%

Maintenance

Depending upon water chemistry, occasional manual cell cleaning may be necessary.

1. Switch off the filter pump and chlorinator/cell power center and close the necessary valves.
2. Unplug the DC cable connector from the cell.
3. Unscrew the electrolytic cell retaining ring and remove the electrolytic cell.
4. Look down into the electrolytic cell to see if there is scale on the plates.
5. Mix the cleaning solution in a suitable plastic container by adding one (1) part of hydrochloric (muriatic) acid to ten (10) parts water. Note: To avoid splash and fumes, always ADD MURIATIC ACID TO WATER rather than water to muriatic acid. Solutions stronger than 1:10 will damage the electrolytic cell and void the warranty. Submerge only the plates of the electrolytic cell in the cleaning solution. Allow the cleaning solution to dissolve the calcium deposits for approximately five (5) minutes.
6. Repeat the procedure if necessary. Take care to avoid splashing the electrolytic cell terminals and other equipment with the acidic cleaning solution. Wash down any spills with plenty of fresh water.
7. Rinse the electrolytic cell in clean water and reinstall it into the vessel. Ensure the O-ring is seated properly and coated lightly with silicone lubricant. Hand-tighten the collar and plug in the DC cable connector and turn the power center back on.

Limited Warranty

Your replacement cell is guaranteed to be free from defects in materials and workmanship, under normal use and non-commercial application, for a period of one (1) year. This limited warranty is subject to the following terms, conditions, and exclusions. To avail the benefits of this warranty, please contact CaliMar® for troubleshooting. Proof of purchase may be necessary. This warranty applies solely to the original retail purchaser and the original installation site, commencing from the original date of purchase, and is non-transferable. This cell is designed for residential pool use, and any commercial application voids all warranties.

If a defect in any covered item or part becomes apparent during the warranty period, CaliMar® will, at its sole discretion, either repair or replace such item or part. CaliMar® reserves the right to substitute defective parts with new or refurbished ones. Labor or transportation costs for equipment or component parts to or from CaliMar® are not covered by this warranty, nor are expenses related to removal, reinstallation, or any such costs incurred in obtaining warranty service. The warranty does not apply to issues arising from circumstances beyond CaliMar's control, including, but not limited to:

- Product discoloration or any other cosmetic or superficial damage, regardless of cause.
- Problems resulting from failure to maintain proper water chemistry levels as per the manufacturer's recommendations outlined in the Owner's Manual.
- Damage caused by tampering, accident, electrical surges, abuse, neglect, unauthorized or unqualified repairs, product alteration, fire, flood, freeze damage, Acts of Nature, or Acts of God.
- Damage caused by over-tightening of threaded components or excessive pressure or stress.
- Damage or premature wear due to improper pool chemistry or failure to maintain pool water chemistry following the recommendations in the owner's manual.
- Damage due to improper installation or connection to improper voltages, including materials and workmanship supplied by others.
- Damage to adjacent concrete, stone, wood, or synthetic surfaces near the swimming pool or spa.
- Damage due to negligence or failure to properly maintain equipment, including clean and tight electrical connections.
- Damage due to improper service, unauthorized equipment modifications, or use of non-genuine replacement parts.
- Damage due to misapplication, misuse, abuse, overuse beyond the recommended cell lifetime (over 10 hours per day), or failure to operate equipment as specified in the owner's manual.
- Material supplied or workmanship performed by others during installation.
- Normal wear items such as O-rings, rubber gaskets, electrical fuses, and circuit-breaker components are not covered by the warranty.

Disclaimers: This limited warranty constitutes the entire warranty and supersedes all other warranties, expressed or implied. This limited warranty grants you specific legal rights, which may vary from state to state. CaliMar's liability shall not exceed the repair or replacement of defective items or parts under the referenced limited warranty terms. Under no circumstances shall CaliMar® or its authorized agent/installer be liable for consequential, special, or incidental damages of any kind, including but not limited to personal injury, property damage, or damage to or loss of equipment. CaliMar® or its agent/installer is not liable for any other expenses that may arise during installation or servicing.



CaliMar® Pool Products USA, Inc.
Manufacturers of Innovative & Quality Pool & Spa Products
sales@calimarpool.com
www.calimarpool.com