

AQUA MARINA

WARNING

For your own safety and that of your equipment, make sure to take the following precautions. Failure to follow warning notices and instruction may result in property damage, serious injury or death.

**INFLATABLE
KAYAK & CANOE
USER'S GUIDE**

GENERAL INFORMATION

SAFETY

Kayak sports can be very dangerous and physically demanding. The users of this product should understand participating in kayak sports may involve serious injury or death. Observe all applicable watercraft laws, and use common sense.

PLEASE KEEP THIS MANUAL IN A SECURE PLACE, AND HAND IT OVER TO THE NEW OWNER WHEN YOU SELL THE CRAFT. RECORD THE "HULL IDENTIFICATION NUMBER" (HIN) WHICH IS PRINTED ON THE KAYAK'S HULL IN THE FOLLOWING BOX:

MANUFACTURER'S CERTIFICATION

AM kayak products comply with the ISO 6185 standard established by International Organization for Standardization.

SAFETY CHECK LIST AND SAFETY WARNING

- It is the owner's responsibility to carefully read the manual and instruct all users in safe operation of this product.
- Retain owner's manual for future reference.
- Get kayak instruction specific to this type of craft.
- Follow the instructions in the Owner's Manual, including the data given on the capacity plate. Uneven distribution of people or loads in the kayak could result in danger.
- Use caution when stepping or climbing aboard the kayak. Step into the center of the kayak for maximum stability.
- Always wear an approved Personal Flotation Device (Life Preserver).
- Wear a helmet when appropriate.
- Do not use in high wind, strong currents, open water or dangerous tides.
- Do not paddle in flood conditions.
- Do not use this product under the influence of alcohol or drugs.
- Do not overload or over inflate
- Do not exceed your paddling ability; be honest with yourself.
- Never tow from another boat or vehicle.
- Know and follow local water safety rules and boating regulations.
- Not a life saving device.
- Not for use by children without adult supervision.
- DO NOT exceed the data given on the capacity plates.
- BEWARE OF OFFSHORE WINDS AND CURRENTS.

MANUFACTURER'S RECOMMENDATION

The total number of persons and total weight shall not exceed the limits printed on the kayak. Please refer to the kayak's hull label for the actual specifications of your product.

KAYAK LABEL FORMAT

1. Standard: EN ISO 6185 PART 1 TYPE III
BS EN ISO 6185 PART1 TYPE III
2. Country of origin
3. Maximum passengers
4. Manufacturer's recommended maximum load capacity
5. Manufacturer's recommended working pressure
6. Hull identification number (HIN)
7. Manufacturer's name and address

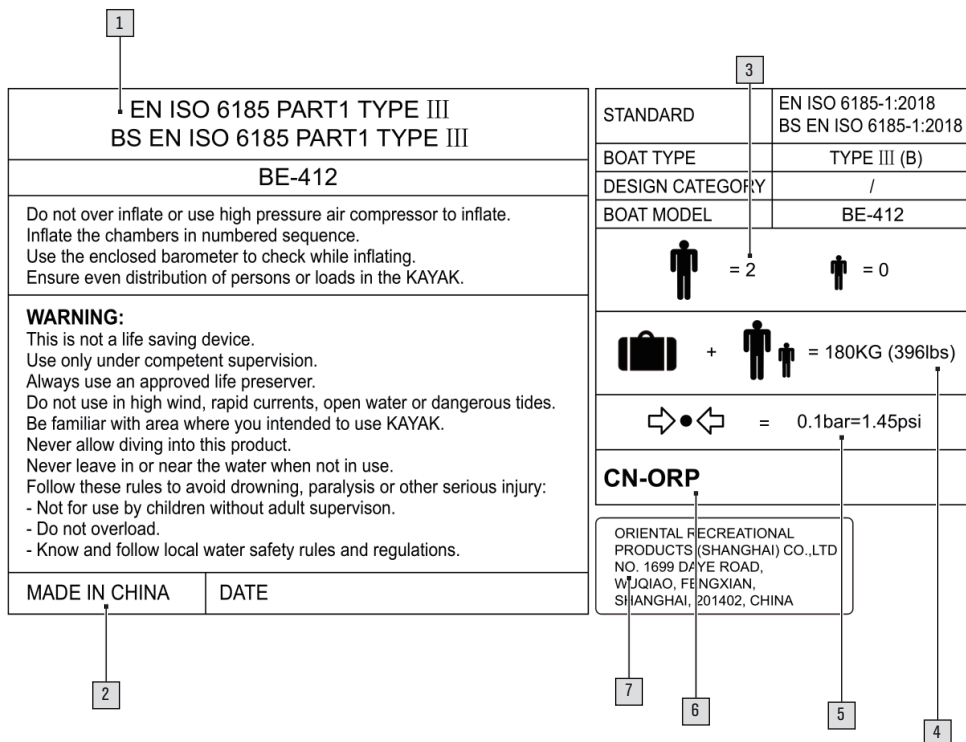

PART LIST

BETTA

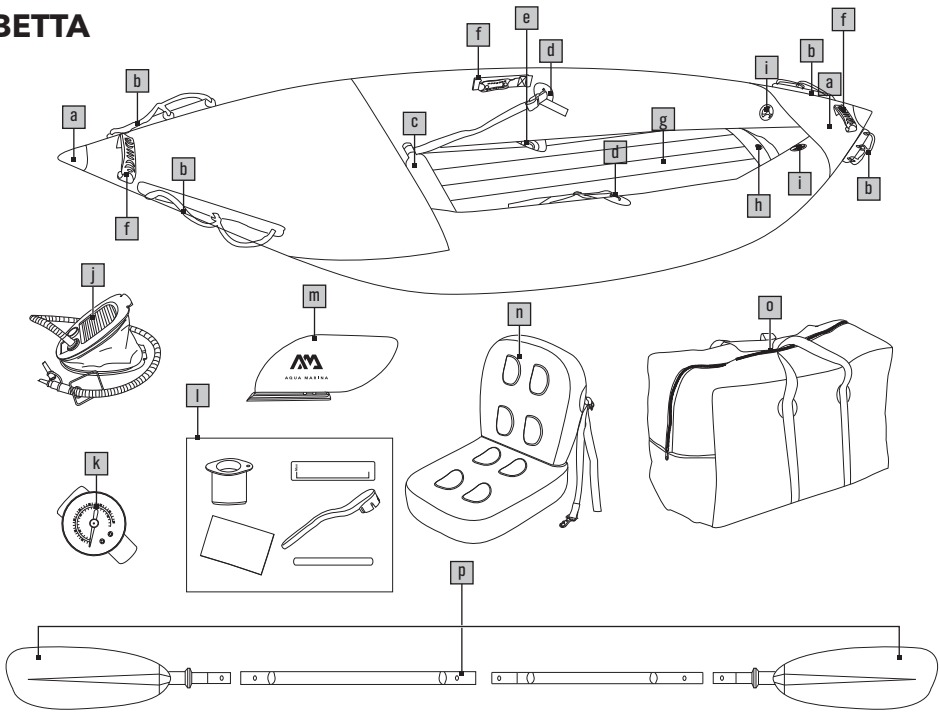

a	Extended water splash guard bow design with hard nose protection	k	Pressure gauge
b	Safety grab rope	l	Repair kit (Adaptor for high pressure valve/ Transparent scale/ Repair patch/ Wrench/ Transparent deflation pipe)
c	Adjustable footrest (BE-312/BE-412/BE-475 x 1)	m	Slide-in kayak fin x 2
d	D-rings for the seat and foot brace	n	Inflatable cushion seat (BE-312 x 1, BE-412 x 2, BE-475 x 3)
e	Integrated drain valve (BE-312 1+2, BE-412/BE-475 1+4)	o	Carry bag
f	Durable rubber carry handle	p	Paddle (BE-312 x 1, BE-412 x 2, BE-475 x 3)
g	Strong inflatable I-beam floor		
h	Valve for I-beam floor		
i	High pressure recessed valve for quick and easy inflation and deflation		
j	11" foot pump with inflation hose		

PART LIST

LAXO

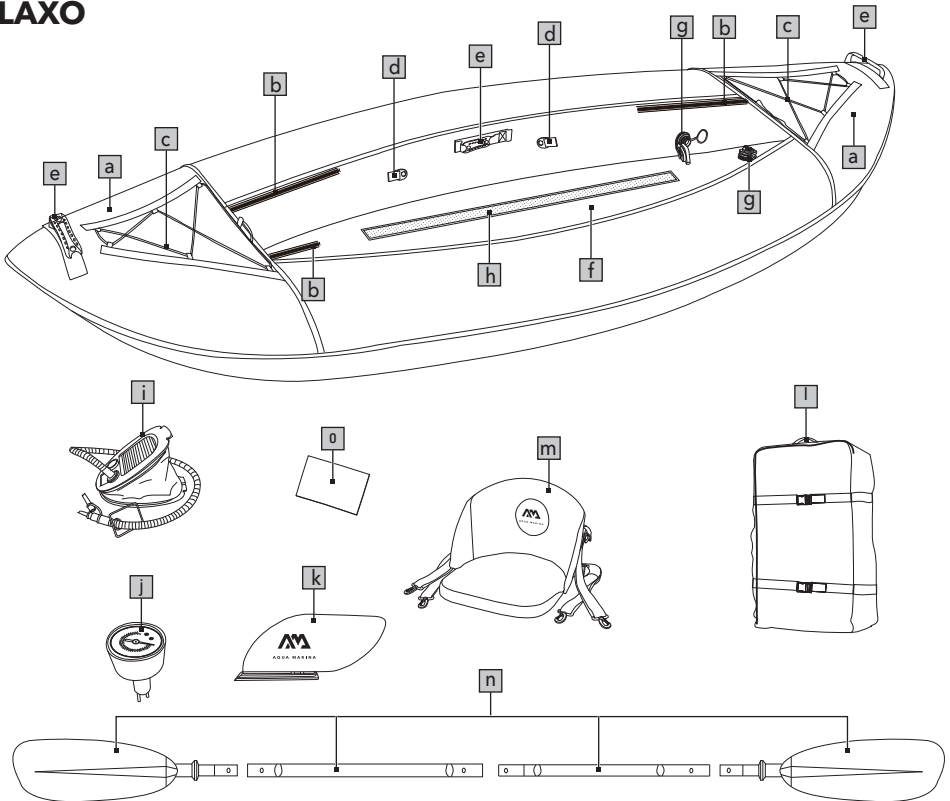

a	Extended water splash guard bow design	j	Pressure gauge
b	Zipper of hull covers	k	Slide-in kayak fin x 2
c	Cargo bungee cord	l	Kayak zip backpack
d	D-rings for seat connection	m	Durable high-back seat (LA-285 x 1, LA-320 x 2, LA-380 x 3)
e	Durable rubber carry handle	n	Kayak paddle (LA-285 x 1, LA-320/LA-380 x 2)
f	Strong inflatable I-beam floor	o	Repair patch
g	Boston valve for the hull		
h	Velcro for removable high-back seat		
i	11" foot pump with inflation hose		

PART LIST

RIPPLE

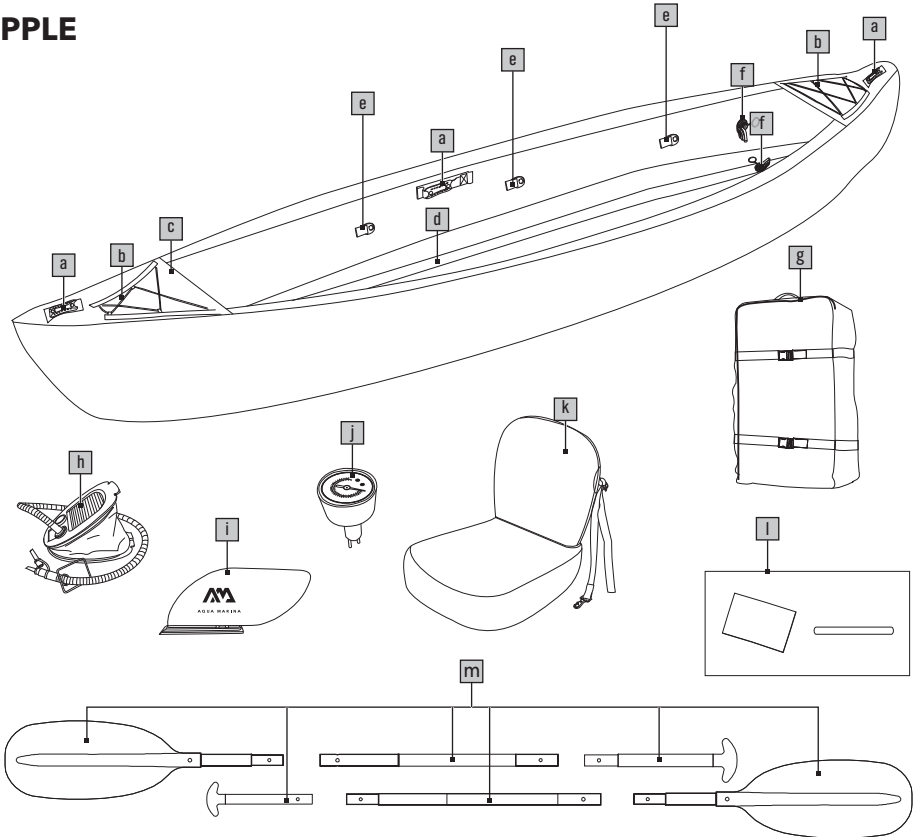

a	Durable rubber carry handle	j	Pressure gauge
b	Cargo bungee cord	k	Durable inflatable high-back seat x 3
c	Extended water splash guard bow design	l	Repair kit (Repair patch/ Transparent deflation pipe)
d	Strong inflatable I-beam floor	m	RIPPLE -TECH paddle x 2
e	D-rings for seat connection		
f	Boston valve for the hull		
g	Kayak zip backpack		
h	11" foot pump with inflation hose		
i	Slide-in kayak fin x 2		

PART LIST

MEMBA

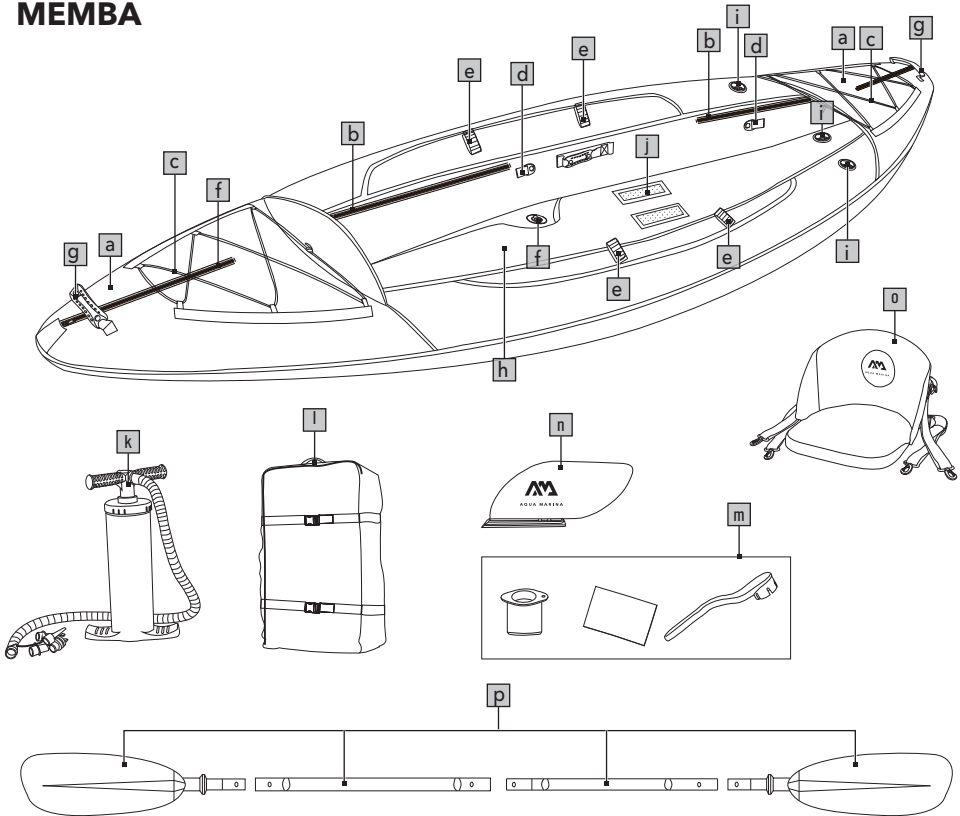

a	Extended water splash guard bow design	k	16" hand pump with inflation hose & gauge
b	Zipper of hull covers	l	Kayak zip backpack
c	Cargo bungee cord	m	Repair kit (Adaptor for high pressure valve/ Repair patch/ Wrench)
d	D-rings for seat connection	n	Slide-in kayak fin x 2
e	Velcro paddle holder design	o	Durable high-back seat (ME-330 x 1, ME-390 x 2)
f	Integrated drain valve	p	Kayak paddle (ME-330 x 1, ME-390 x 2)
g	Durable rubber carry handle		
h	7cm drop-stitch air deck floor		
i	High pressure recessed valve for quick and easy inflation and deflation		
j	Velcro for removable high-back seat		

PART LIST

STEAM

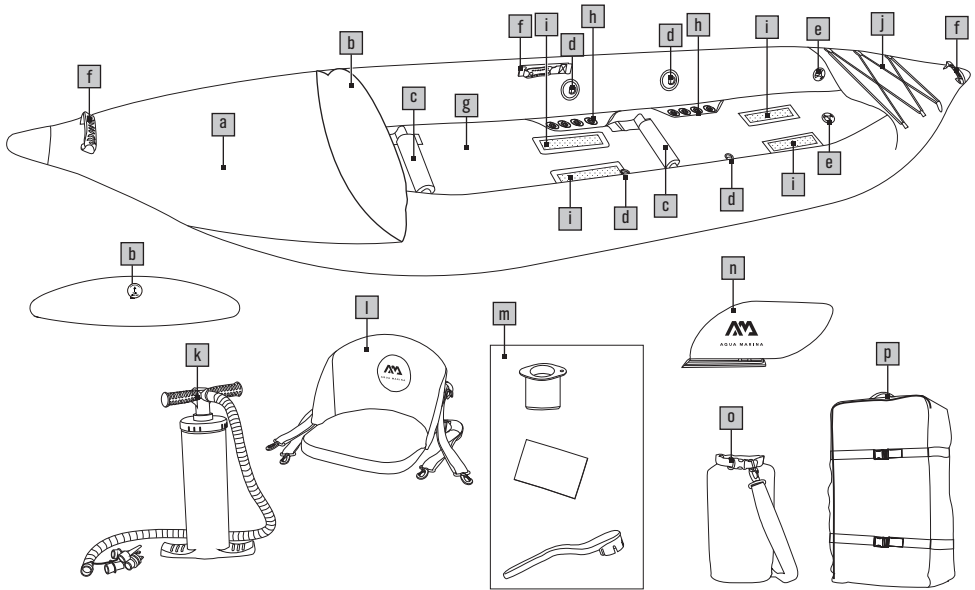

a	Extended water splash guard bow design with hard nose protection	k	16" hand pump with inflation hose & gauge
b	Deck Shield	l	Durable removable high-back seat (ST-312 x 1, ST-412 x 2)
c	Adjustable footrest (ST-312 x 1, ST-412 x 2)	m	Repair kit (Adaptor for high pressure valve/ Repair patch/ Wrench)
d	D-rings for the seat	n	Slide-in kayak fin x 2
e	High pressure recessed valve for quick and easy inflation and deflation	o	10L Dry bag
f	Durable rubber carry handle	p	Kayak zip backpack
g	7cm drop-stitch air deck floor		
h	Superfast self-bailing drain valves (ST-312 1+8, ST-412 1+16)		
i	Velcro for removable high-back seat		
j	Stern elastic bungee cord design		

SPECIFICATIONS

Model	Length	Width	Max. Passenger	Capacity	Net Weight	Air Chambers
BETTA BE-312	312cm (10'3")	80cm (31")	1	110kg (242 lbs)	8.5kg (18.7lbs)	2+1
BETTA BE-412	412cm (13'6")	80cm (31")	2	180kg (396 lbs)	11.8kg (26lbs)	2+1
BETTA BE-475	475cm (15'7")	80cm (31")	3	230kg (507 lbs)	15kg (33.1lbs)	2+1
LAXO LA-285	285 cm (9'4")	90cm (35")	1	110 kg (242 lbs)	11.5 kg 25.4 lbs	2+1
LAXO LA-320	320 cm (10'6")	90cm (35")	2	180 kg (396 lbs)	12 kg 26.5 lbs	2+1
LAXO LA-380	380 cm (12'6")	90cm (35")	2+1	210 kg (462 lbs)	17.5 kg 38.6 lbs	2+1
RIPPLE RI-370	370 cm (12'2")	85cm (33")	3	230 kg (507 lbs)	18.5 kg 40.8 lbs	2+1
MEMBA ME-330	330 cm (10'10")	90cm (35")	1	110 kg (242 lbs)	13.4 kg 29.5 lbs	2+1
MEMBA ME-390	390 cm (12'10")	90cm (35")	2	180 kg (396 lbs)	17 kg 37.5 lbs	2+1
STEAM ST-312	312cm (10'3")	90cm (35")	1	110kg (242 lbs)	11.5kg (25.4lbs)	2+1
STEAM ST-412	412cm (13'6")	90cm (35")	2	180kg (396 lbs)	15.5kg (34.2lbs)	2+1

INSTRUCTION FOR ASSEMBLING AND DISASSEMBLING

INFLATION

1. Unfold the KAYAK from the packaging box.

Unfold the Aqua Marina kayak on a clean and smooth space and lay it out flat.

2. Attach the pump hose to the pump and secure it tightly.

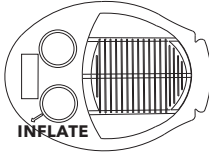

11" FOOT PUMP FOR BETTA/ LAXO/ RIPPLE

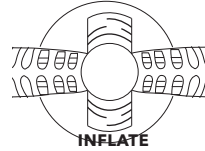

16" HAND PUMP FOR MEMBA/ STEAM

3. Connect the pump hose to the valve for inflation.

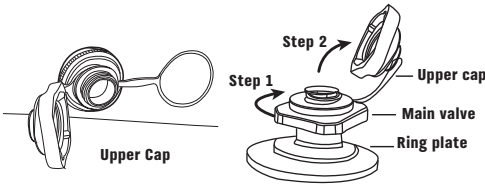

BOSTON VALVE (For LAXO/ RIPPLE)

Step1: Ensure that the main valve is securely screwed into the ring plate first.

Step2: Open the upper cap of the Boston valve for inflation.

In this situation, the valve only lets air in, not out.

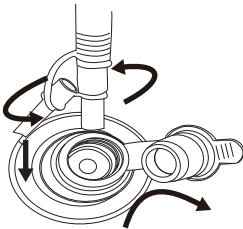

PINCH VALVE (For BETTA's floor)

Open external cap and pull firmly to extend out.

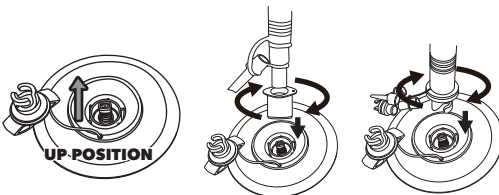

HIGH PRESSURE VALVE (For BETTA/ MEMBA/ STEAM)

Unscrew the valve cap, push button in and turn 90 degrees to make sure that the valve button pops up to the "UP position" for inflation.

4. Start pumping air into the side chambers and the floor of the kayak according to the inflation sequence as suggested in the below table.

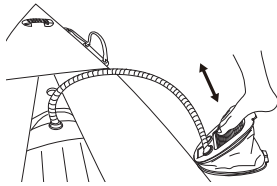
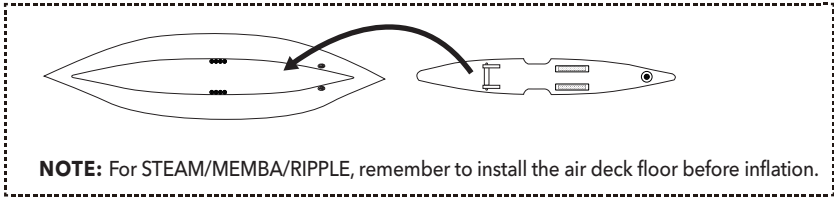

11" Foot Pump for BETTA/ LAXO/ RIPPLE

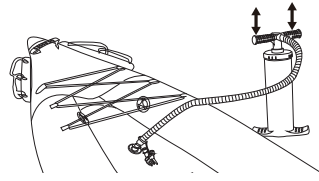

16" Hand Pump for MEMBA/ STEAM

Keep inflating until the required air pressure is reached. DO NOT OVERFILL!

TIP: Working pressure of each part should NOT exceed the maximum as below.

	Inflation Sequence	Side Chambers	Floor
BETTA	Floor → Side Chambers	1.45psi / 0.1bar	Refer to the transparent scale.*
LAXO	Floor → Side Chambers	1psi / 0.07bar	1psi / 0.07bar
RIPPLE	Floor → Side Chambers	1psi / 0.07bar	1psi / 0.07bar
MEMBA	Side Chambers → Floor	1psi / 0.07bar	4.35psi / 0.3bar
STEAM	Side Chambers → Floor	1.45psi / 0.1bar	4.35psi / 0.3bar

***IMPORTANT!**

For BETTA, please use the transparent scale (come with the repair kit bag) to check if the kayak floor is properly inflated. The black line should NOT be longer than the MAX. scale.

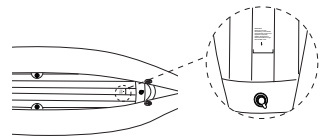

WARNING: Do not leave your kayak/canoe under direct sunlight as this may cause over-inflation!



PARTIALLY INFLATE THE SIDE CHAMBERS AND THE KAYAK FLOOR AND CHECK THAT THE FLOOR IS TUCKED UNDERNEATH THE SIDES.

5. Once inflated, firmly cap each valve.

NOTE: After multiple times of inflation - deflation, there may be slight displacement of the valve. Replace it to the correct position when deflated. Then inflate to required air pressure to use.

TIP: If the pump piston starts to squeak, apply some spray silicone on the piston shaft.

SEAT INSTALLATION

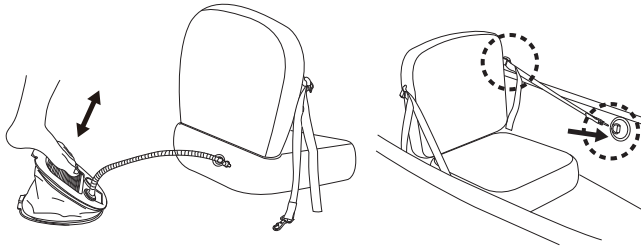

BETTA/ RIPPLE

1. Inflate the seat with the foot pump.
2. Once seat position is confirmed, connect the seat straps to the D-rings by using strap buckles. Attach the upper straps to the D-rings forward of each seat.

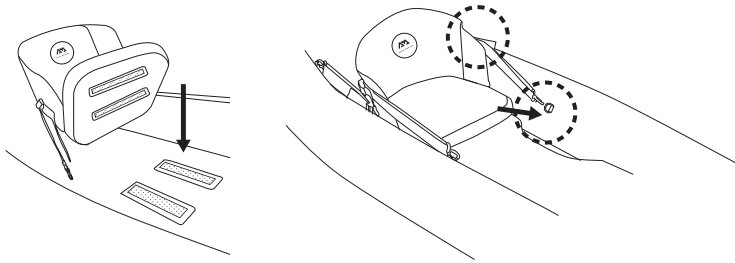

LAXO/ MEMBA/ STEAM

1. Attach the seat to the kayak floor with Velcro.
2. Once seat position is confirmed, connect the seat straps to the D-rings by using strap buckles. Attach the upper straps to the D-rings forward of each seat.

NOTE:

1. It is important to place the seat in the right place to evenly balance the boat when in the water. A solo paddler should be slightly aft of the boat's center. With two paddlers, the heavier one should sit toward the rear.
2. Seat position could be easily adjusted by clipping strap buckles to different D-rings, and strap buckles may be clipped to the same D-ring if needed.

KAYAK FIN INSTALLATION

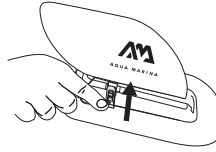
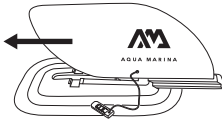

Turn the kayak over. Slide the kayak fin into the fin box and insert the push-in pin.

NOTE: The kayak fins need to be installed if you use the kayak on flat water.

DO NOT USE KAYAK FINS IN WHITE WATER.

WHEN USING THE KAYAK IN FLAT-WATER, SCREW THE DRAIN CAPS DOWN TIGHTLY. OPEN THE CAPS BEFORE ENTERING WHITEWATER. THE KAYAK WILL BE PARTIALLY FILLED WITH WATER WHEN THE DRAIN VALVES ARE OPEN.

TIPS:

WHEN OPENING THE DRAINS, TUCK THE CAPS UNDERNEATH THE INFLATABLE FLOOR SO THEY DO NOT BLOCK THE OPENING AS WATER DRAINS OUT.

DECK SHIELD SET-UP

STEAM

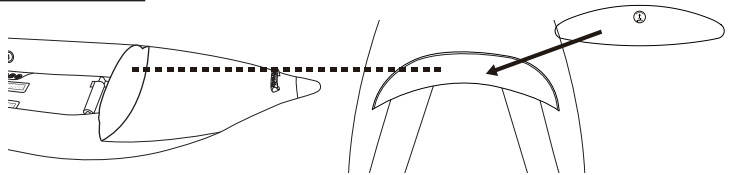

DEFLATION

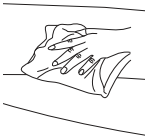

1. Clear any water or debris out of the valve areas.

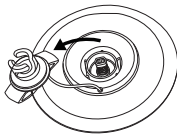

2. Open valve caps to start deflation.

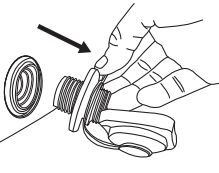

BOSTON VALVE (For LAXO/ RIPPLE)

Open the main valve of the Boston valve for deflation. In this situation, the valve only lets air out, not in.

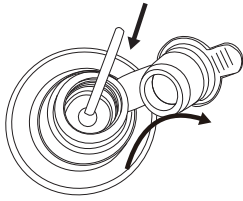

PINCH VALVE (For BETTA's floor)

Open external cap and pull firmly to extend out. Start to deflate by using the transparent deflation pipe (comes with the repair kit bag), or by simply squeezing the bottom of the valve.

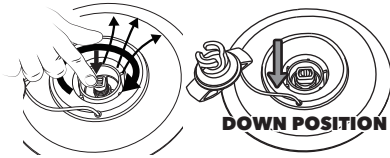

HIGH PRESSURE VALVE (For BETTA/ MEMBA/ STEAM)

Slowly press down on the valve button to let air out of the kayak. There will be an initial burst of air, but will slow down very quickly.

Once the air flow has slowed down, push valve button in and turn 90 degrees to make sure that valve button is locked in "DOWN position" for deflation.

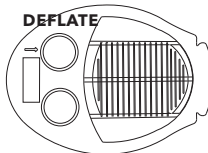
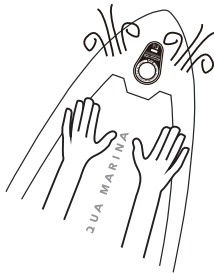

11" FOOT PUMP
FOR BETTA/ LAXO/ RIPPLE

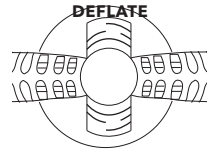

16" HAND PUMP
FOR MEMBA/ STEAM

- 3. Deflate by squeezing out the remaining air. Or by using the pump on "DEFLATE" mode.
- 4. Once deflated, firmly cap each valve.

FOLDING STEPS

- 1. Remove all the accessories from the kayak: seats, paddles, kayak fins, etc.

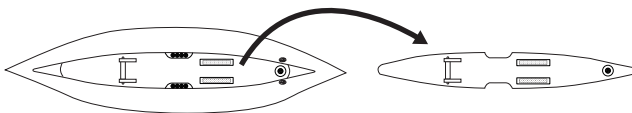

NOTE: For STEAM/MEMBA/RIPPLE, remember to remove the air deck floor before folding.

NOTE: For STEAM, remember to remove the Deck Shield before folding the kayak.

2. Refer to the following folding steps for different models.

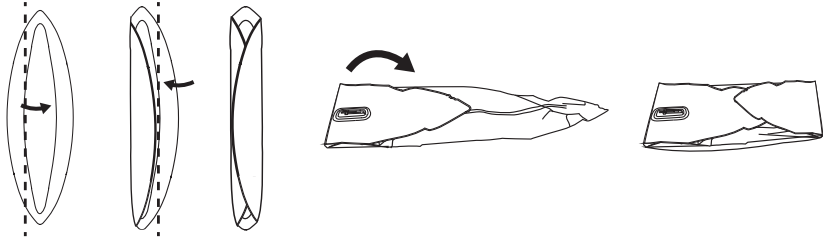

BETTA/RIPPLE/ LAXO/ MEMBA

After deflation, tri-fold the tubes of the kayak. Then, fold the bow to the middle and force out any remaining air. Repeat this procedure for the stern, and place bow folds on top of stern.

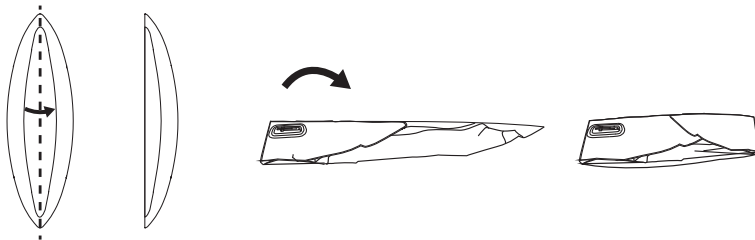

STEAM

After deflation, fold the kayak in half the long way. Then, fold the bow to the middle and force out any remaining air. Repeat this procedure for the stern, and place bow folds on top of stern.



NOTE:

Please avoid bending the fin box.

3. The kayak bag is designed to allow you to get your kayak into the bag as easily as possible with minimal folds. *Side pocket of the zip backpack is designed to store kayak pump.

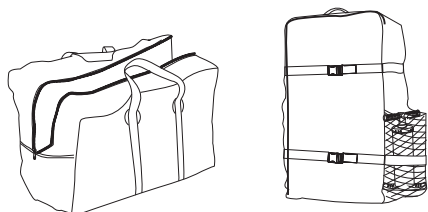

PADDLE ASSEMBLY

KAYAK PADDLE (* Optional for STEAM)

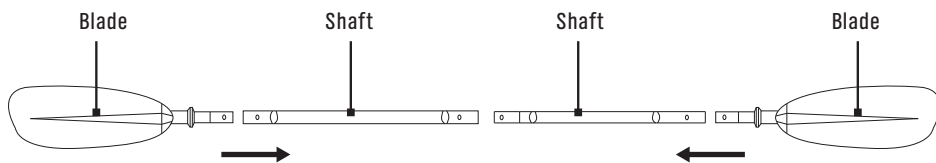

RIPPLE-TECH PADDLE (Only for RIPPLE)

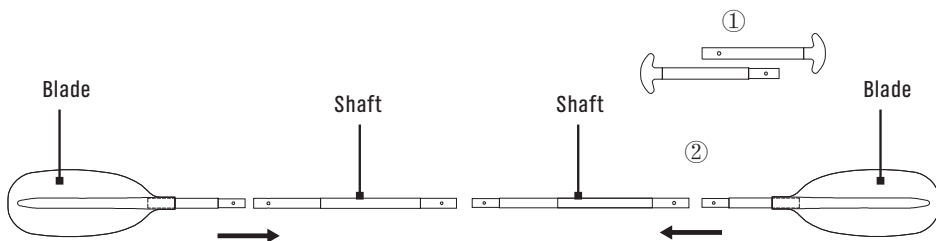

① Canoe Paddle

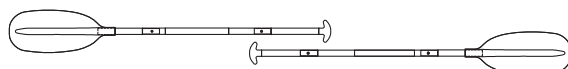

② Kayak Paddle



KAYAK PADDLE ASSEMBLY

1. Press and align the push-bottom on the paddle blade with the short shaft hole, ensure the push-bottom is securely snapped into the short shaft hole.
2. Join the 2 shafts together by pressing and aligning the push-bottom securely snapped into the hole.
3. To disassemble, reverse the assembly steps.

Note: it is not necessary to detach the paddle blades from the shafts.



NOTE: ALWAYS DRAIN THE WATER LEFT IN THE PADDLE SHAFT AFTER EACH USE.

INSTRUCTION FOR CARE AND STORAGE

The kayak is made of the highest quality materials and complies with ISO 6185 standards. Altering the construction of the kayak will endanger your own safety, safety of the occupants and void the limited warranty!

There is very little that you have to do to keep your kayak in good condition for many years.

- Clean your kayak after a trip to prevent damage from sand, salt water or sun exposure.

Most dirt can be removed with a garden hose, a sponge and mild soap. Make sure the kayak is completely dry before being stored. Use as few cleaning agents as possible, do not discharge waste agents into water, and clean your kayak preferably on land.

- The products may be stored inflated, but do not place any heavy or sharp objects on it.

Hanging the kayak is not recommended.

- Store your kayak in a dry room.
- Take protection method to keep your kayak away from rodents or other vermin, as they may bite the product.
- The room temperature shall be maintained between 0°C (32°F) and 40°C (104°F).

WARRANTY

AM warrants this product to be free from major defects in material or workmanship to the original purchaser for below specified period from the date of purchase. This warranty is subject to the following limitations:

- **BETTA kayaks have a limited SIX (6) months warranty.**
 - **LAXO/ RIPPLE/ MEMBA/ STEAM kayaks have a limited TWELVE (12) months warranty.**
1. The warranty is valid only when this product is used for normal recreational activities and does not cover products used in rental or school operations
 2. AM will make the final warranty determination, which may require inspection and/or photos of the equipment, which clearly show the defect(s). If necessary, this information must be sent to the AM distributor in your country with prepaid postage. Product can be returned only if a return authorization number is given in advance by the AM distributor. The return authorization number must be clearly labeled on the outside of the package, or it will be refused
 3. If a product is deemed to be defective by AM, the warranty covers the repair or replacement of the defective product only. AM will not be responsible for any costs, losses, or damages incurred as a result of loss or misuse of this product
 4. This warranty does not cover damage caused by misuse, abuse, neglect, normal wear and tear including, but not limited to, punctures, damage due to excessive heat exposure, damage caused by improper handling and storage, damage caused by use in waves or shore break, board breakage caused by filling or crashing in surf conditions, or damage caused by anything other than defects in material and workmanship
 5. This product must not be modified and/or fitted with a motor except AM BlueDrive power fin
 6. This product must not be used in excess of the manufacturers recommended maximum load capacity
 7. This warranty is void if any unauthorized repair, change or modification has been made to any part of the equipment
 8. The warranty for any repaired or replacement equipment is good from the date of the original purchase only
 9. The original purchase receipt must accompany all warranty claims. The name of the retailer and date of purchase must be clear and legible
 10. There are no warranties that extend beyond the warranty specified here in



THIS PRODUCT IS DESIGNED IN ACCORDANCE WITH STANDARDS FOR A SPECIFIC USE. ANY MODIFICATIONS OR TRANSFORMATIONS HIGHER THAN THAT INDICATED BY THE MANUFACTURER COULD RESULT IN SERIOUS RISKS FOR THE USER AND WILL VOID THE WARRANTY.

JOIN AQUA MARINA COMMUNITY



AM Official Site



AM HOW-TO Guide



AM Service Center List

KEEP UPDATED

Sign up to receive communications from Aqua Marina to keep updated with our latest products and news.

I would like to receive communications from Aqua Marina.
You can unsubscribe from these communications at any time. We take the protection of your data seriously. For more information on our privacy practices, please review our Privacy Policy.

FIND YOUR WONDERLAND

Check out our social media sites to get involved and find out more.



<https://www.facebook.com/aquamarinaglobal>



<https://www.instagram.com/aquamarinaglobal>



<https://twitter.com/aquamarinasup>



<https://www.youtube.com/c/AquaMarinaGlobal>